

Image Quality  
Due to Condition  
Of Original

Form B.

NEW ZEALAND.



Register-book,

Vol. 8, folio 223

Reference: { Vol. , folio  
Transfer No.

1117

CERTIFICATE OF TITLE UNDER LAND TRANSFER ACT.

This Certificate, dated the fourteenth day of November, one thousand eight hundred and eighty seven under the hand and seal of the District Land Registrar of the Land Registration District of Westland Witnesseth that

The Hokitika Harbour Board  
under and by virtue of The Hokitika Harbour Board Endowment Act 1878

is seized of an estate in fee-simple <sup>ANN</sup> (subject to such reservations, restrictions, encumbrances, liens, and interests as are notified by memorial under-written or indorsed hereon, subject also to any existing right of the Crown to take and lay off roads under the provisions of any Act of the General Assembly of New Zealand) in the land hereinafter described, as the same is delineated by the plan hereon bordered <sup>ANN</sup> situated in Blocks III IV VII VIII XII and XVI Ranine Survey District and Blocks V IX and XIII Teaiwhate Survey District <sup>ANN</sup> be the several admeasurements

a little more or less, that is to say: All that parcel of land containing <sup>ANN</sup> as the same is delineated by the plan hereon bordered red be the said admeasurements a little more or less that is to say All that parcel of land containing fourteen thousand one hundred and fifty acres situated in the Arakura District in the Provincial District of Westland known as Reserve No 1165 in red subject to Government Reserves and Reserves for Road, tramway, or railway purposes, and exclusive of Section 167b and prescriptive right existing Reserves and Gold workings and subject to such reservations restrictions encumbrances liens and interests as are notified by Memorial underwritten or indorsed hereon subject also to any existing right of the crown to take and lay off roads under the provisions of any act of the General Assembly of New Zealand



W. H. King  
District Land Registrar  
of the District of Westland

Mortgage No 785 (copy of above)  
**DISCHARGED** by the Hokitika Harbour Board  
to J. H. King (the Queen) produced  
the 6th day of June 1898 at 2pm  
W. H. King

Lease 900 produced 25th February 1907 at 3pm The  
Hokitika Harbour Board to The Consolidated Gold  
Fields of New Zealand Limited (133 ac 2 ro 11 per cent)  
(Term to expire from 2nd February 1909) A. Jackson  
D.L.R.

Order in Council pronounced 3rd May 1910  
at 10 am whereby the Proclamation declaring  
the within Reserve subject to the provisions of  
the laws relating to mining was revoked  
as from the 1st April 1910 - provided that  
such Revocation shall not affect any  
mining privileges then existing granted -

now  
68 A

Transfer 6983 The Hokitika Harbour Board  
to Fuller Bros Limited produced 1st  
November 1923 at 10.30 am E. C. ...  
Dist. Land Reg.

Over

Proclamation 292 taking portion of within  
land (Hass Bros 946) as coloured red on  
the plan hereon <sup>for road purposes</sup> and closing road coloured  
green on the plan hereon produced  
7<sup>th</sup> December 1952 at 11 am.

27580 Transfer of lot 1 D.P. 1420 Butter Bros  
Limited to Frederick John Smith and Richard  
Thomas Jones as tenants in common in equal  
shares produced 21/5/1962 at 2.45 p.m.  
~~6/2/52~~ 1A/1

27582 N.C.O. cancelled as to balance  
21/5/1962 and N.C. issued Vol 62 1A  
who 2803

Cancelled  
except as to road

dup. destroyed

CERTIFICATE OF TITLE,

Vol. , folio

# NEW ZEALAND

[CERTIFICATE OF TITLE.]

(C)

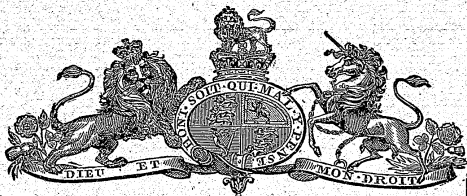

Register Book,

Vol. 8 Folio 228

### Synopsis of Area

Reserves etc:	
Mt Brown Creek	13 0 00
Brentnall's "	8 0 00
Granite "	6 4 00
Smiths "	4 0 00
Caledonian "	13 0 00
Road to Kawheka Tramway	16 0 00
Remnant Lane to Arathura River Road	9 0 00
Road from Arathura River to Christchurch Rd	8 0 00
Road Reserves along Mt Brown Creek	26 0 00
" " Caledonian	26 0 00
Other Creeks	16 3 27
Pre-emptive right E. of Arathura River (lapsed)	792 0 00
<b>Total Reservations</b>	<b>2008 3 27</b>
Freehold Section 1676	7971 0 00
	<b>2008 3 27</b>

<b>Total Area</b>	<b>16158 3 27</b>
<b>Deduct Freehold Section 1676 and reservations etc, etc,</b>	<b>2008 3 27</b>
<b>Nett Area</b>	<b>14150 0 00</b>

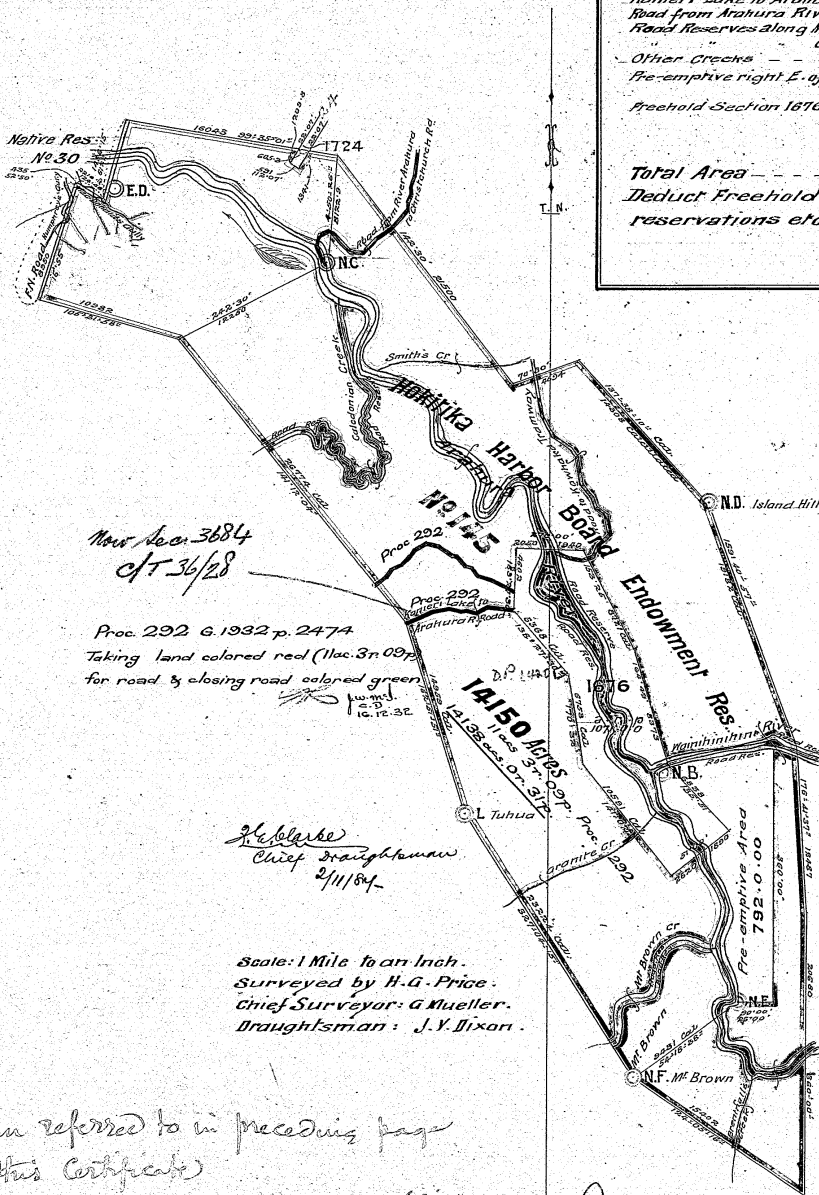

Now Acc. 3684  
C/T 36/28

Proc. 292 G. 1932 p. 2474  
Taking land colored red (11ac. 3n. 09)  
for road by closing road colored green.  
16. 12. 32

H. Clarke  
Chief Draughtsman  
2/11/84

Scale: 1 Mile to an Inch.  
Surveyed by H.G. Price.  
Chief Surveyor: G. Mueller.  
Draughtsman: J.V. Dixon.

Plan referred to in preceding page  
of this Certificate



W. H. Price  
S. J. Dixon

Plan 1420

